

Treatment Room to Control Room Intercom System

1 of 3

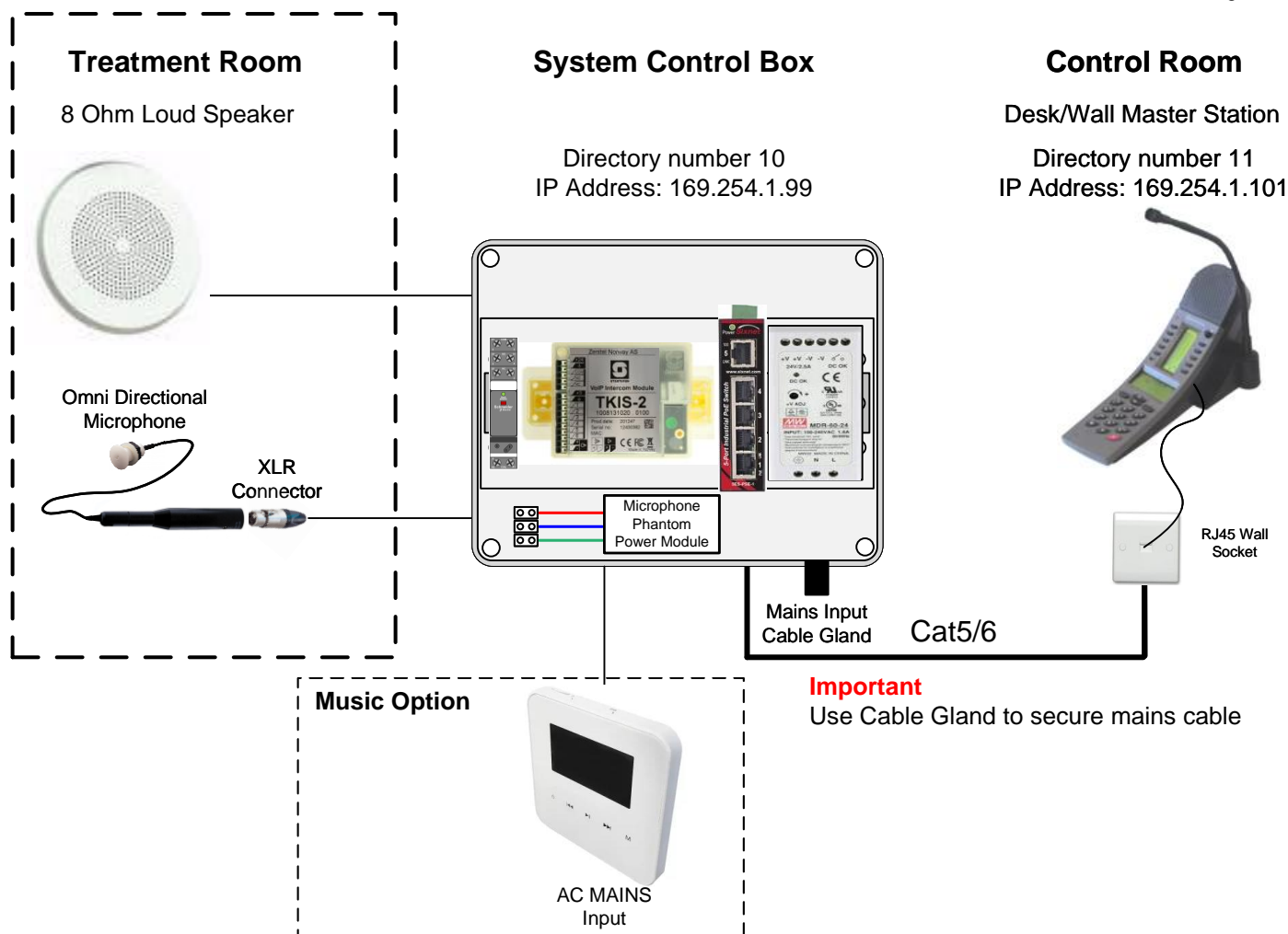

Installation

Desk/wall station should be mounted with easy access to controls.
 System Control Box can be mounted in the control room with access for maintenance.
 Cable between Desk/wall Station and the System Control Box is CAT5/6 cable.
 Cable for microphone should be microphone cable, 2 core plus Screen.
 The speaker requires 2 core speaker cable, use same type cable between music interface if fitted.

Recommendations

Microphone must be fitted where it can pickup speech and not equipment noise. Keep away from aircon units.
 If you have a fixed ceiling we suggest Loudspeaker and Microphone are spaced at arms length apart so fixing of the microphone fixing nut and making off connections can be achieved through the aperture for the speaker.

Operation

To communicate with the patient on the Treatment Room, press the Star key "*", then press and hold the "M" key to talk to the patient, let go to return to listen mode.

Patient in the Treatment room, cannot hear operator without the "M" key is being pressed.
 When Pressing the "M" key, relay will cut music from music interface (if fitted).

Close System

To cancel all communications (Switch OFF) press Cancel.
 Music will still be heard from music interface to speaker.
 Press ON/OFF button on music interface to turn OFF, then switch off music source.

Treatment Room to Control Room Intercom System

2 of 3

